



VRD37_{CO2}

Establishing a NEW STANDARD in the commercial refrigeration industry.

This innovative two door cooler combines a large display capacity with the maximum energy efficiency.



KEY FEATURES



ELECTRONIC TEMPERATURE CONTROLLER

Assures the optimal performance of the cooler, delivering product temperature ideal for consumption.



ECO-FRIENDLY REFRIGERANTS CO₂

Alternative refrigeration gases that do not contain HFCs and thus reduce the environmental impact.



ELECTRONIC FAN MOTORS

Enhances performance and efficiency. Uses only a fraction of the energy than industry standard shaded-pole motor requires. Longer useful life fan motor.



HIGH EFFICIENCY GLASS DOOR

Equipped with double panel glass and low-e film to reduce condensation. Door hinge is equipped with a self-closing system to ensure the door closes safely, and returns to original position, without any damages.



LED LIGHTING SYSTEM

Our LED system uses a fraction of the energy of regular fluorescent lights and requires no replacement for up seven years.



CYCLOPENTANE INSULATION

Eco-friendly, recyclable and high efficiency cabinet insulation.



PLASTIC FRONT GRILL

Its differentiated and modern design provides superior impact resistance and is easy to remove for condenser maintenance.



COMMERCIAL REFRIGERATOR
AND/OR FREEZER
9242

NSF/ANSI 7 COMMERCIAL REFRIGERATOR
AND/OR FREEZER
201Y

VRD37_{CO₂}

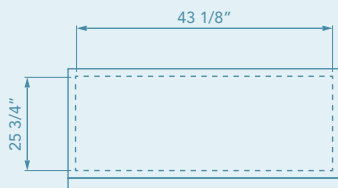

TOP VIEW

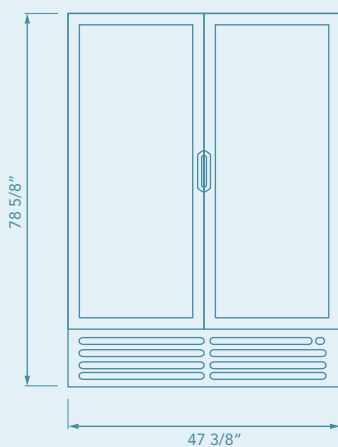

FRONT VIEW

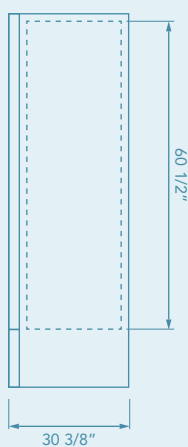

SIDE VIEW

TECHNICAL SPECIFICATIONS

External Dimensions	H:	78 5/8"	1997 mm
	W:	47 3/8"	1203 mm
	D:	30 3/8"	770 mm
Internal Dimensions	H:	60 1/2"	1537 mm
	W:	43 1/8"	1095 mm
	D:	25 3/4"	652 mm
Weight	Gross:	445.3 lb	202.0 kg
	Crated:	449.7 lb	204.0 kg
Volume		37.4 ft ³	1059.6 lts
Capacity	53':		31
Doors		2	
Shelves		10	
20 oz bottle capacity	Total:		490
	Front:		7
12 oz can capacity	Total:		882

REFRIGERATION DATA

Energy Consumption (kWh/24h)	5.170*
Refrigerant R744 (kg)	0.300
Compressor (W)	1120
Evaporator	Dynamic
Temp range	0°C to 7°C

ELECTRICAL DATA

Amps (A)	9.1
Volts (V)	115
Frequency (Hz)	60
Lighting	LEDs
Cord Length	118" 3000 mm
Plug type	NEMA 5-15P



IMBERA USA L.L.C.

245 TownPark Drive Suite 145
Kennesaw, GA 30144

www.imeracooling.com

* Energy consumption based on ANSI/ASHRAE 72-2005

BMAD System (Low maintenance high performance).
Dimensions rounded up to the nearest inch or millimeter.
Specifications subject to change without notice.