

VRA-12 DOUBLESIDED

This double-sided open-air cooler was designed for checkouts and gondolas, offering a unique opportunity to cross merchandize products.



KEY FEATURES



ELECTRONIC TEMPERATURE CONTROLLER:

Our standard controller maintains temperature efficiently based on surrounding conditions, self adjusting to the right temperature for your products.



LED PERIMETER LIGHTING:

LED lighting system, uses a portion of the energy of regular fluorescent lights, and need no replacement for seven years.



CYCLOPENTANE INSULATION:

CFC and HFC free Cyclopentane foam is eco-friendly and a high efficiency insulator.



PLASTIC HEADER:

Our highly durable and resistant plastic parts do not rust and can be fully recycled at the end of the cooler's life cycle.



VRA-12 DOUBLESIDED

TECHNICAL SPECIFICATIONS

External dimensions	H: 60 1/4"	1532 mm
	W: 17 3/8"	441 mm
	D: 42 7/8"	1088 mm
Internal dimensions	H: 36 1/4"	920 mm
	W: 14 3/8"	366 mm
	D: 13 3/4"	340 mm
Weight	Gross: 264.5 lb	120 kg
	Crated: 308.6 lb	140 kg
Capacity ¹	8.09 ft ³	228.97 lts
Trailer load	53: 70	
Doors	N/A	
Shelves	6	
20 oz bottle capacity	Flat shelves: 96	
	Gravity feed: N/A	
	Front facing: 4	
12 oz can capacity	Total: 240	

TOP VIEW

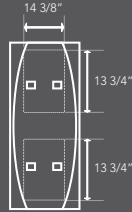

FRONT VIEW

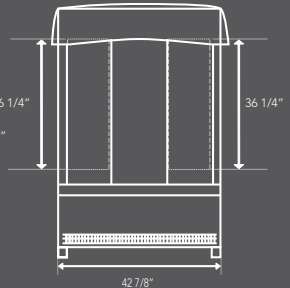

SIDE VIEW

REFRIGERATION DATA

Energy consumption	10.58 Kwh/24h*
Refrigerant	R-134a
Compressor	1/2 hp
Evaporator	Forced air
Temp. range	32 °F to 44.6 °F

ELECTRICAL DATA

Amps	9.4 A*	
Voltage	115 V	
Lighting	LEDs	
Cord length	120"	3048 mm
Plug type	NEMA 5-15P	



¹Based on ANSI/AHAM HRF-1

*Based on ANSI/ASHRAE 72-2005

Metric dimensions rounded up to the nearest inch and millimeter.

Specifications subject to change without notice.

Imbera USA L.L.C.
www.imbera.mx

303 Perimeter Center North Suite 300 Atlanta, GA 30346
Ph: +1 (678) 690 8454 Fax: +1 (678) 690 8455

WARRANTY

One year limited warranty on all parts and labor, an additional 4 year warranty on compressor. (USA and Canada only)